

Installation Instructions for PD30Z Snow Guard

1. Set the snow guard on the face of the metal shingle as shown in Figure #1.
2. Push the top of the snow guard strap (the end with the nail holes) up into the lock of the shingle course just above. Push the strap up as far as the lock will allow, while leaving the nail holes accessible.
3. Install two fasteners through the holes in the snow guard strap, directly through the face of the shingle below, and into the underlying wood deck. Caulk the heads of the fasteners.
4. Slide the sleeve up over the fasteners as far up into the lock as possible. This counter-flashes the fasteners. The caulking from the fastener heads will hold the sleeve in place.
5. Move to next snow guard.

Figure #1

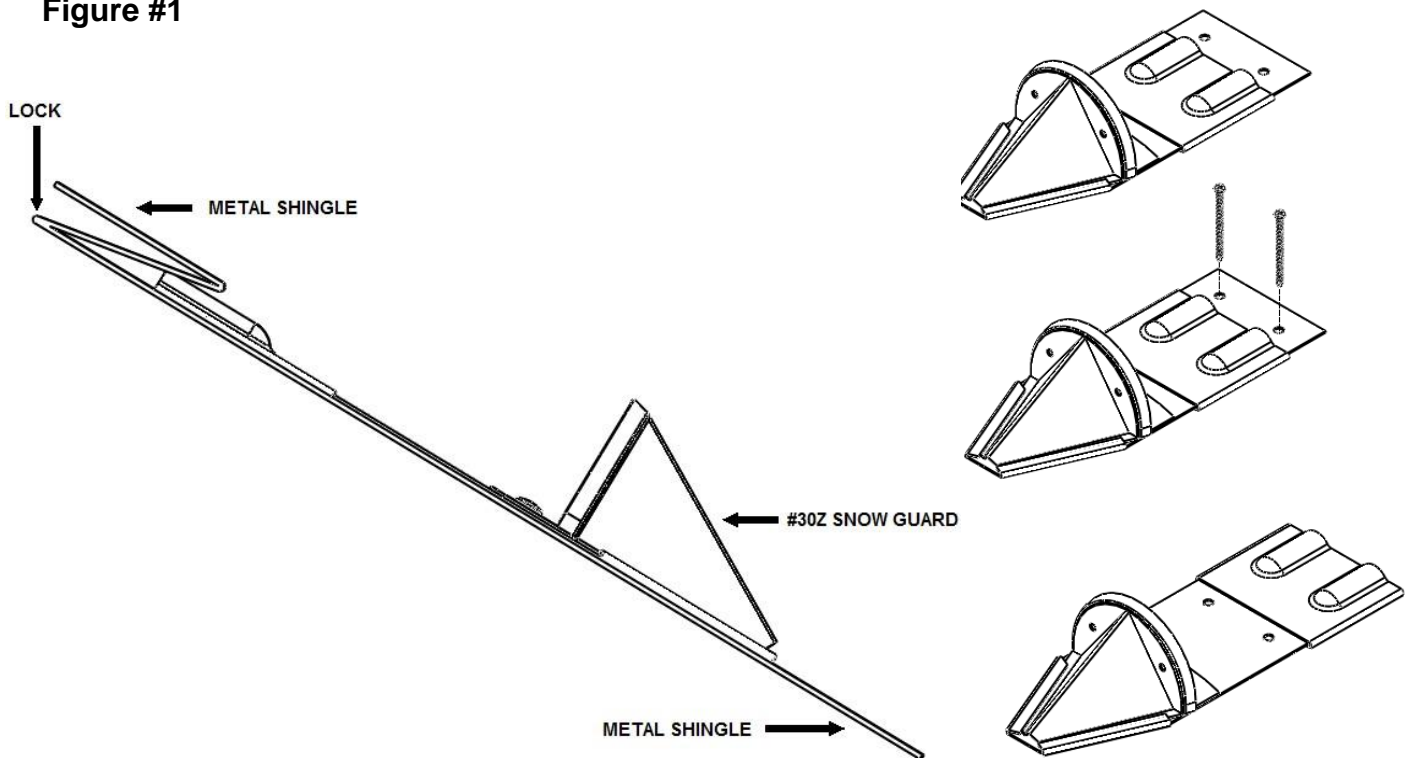

Standard 2 X 4 Layout Using 12 Snow Guards Per Square

The image below shows a sample installation of a roof with a rafter length greater than 15', a roof pitch of 16/12 or less and a Ground Snow Load of less than 75 psf. If roof pitch is greater than 16/12 please contact Alpine SnowGuards for more information. All snow guard installations must have the standard three row pattern along the eave. Remaining snow guards should be evenly spaced between the top of the three-row pattern to within 10' of the ridge. If the rafter length is less than 15' you only need the three-row pattern which requires 17 snow guards per 10' of eave.

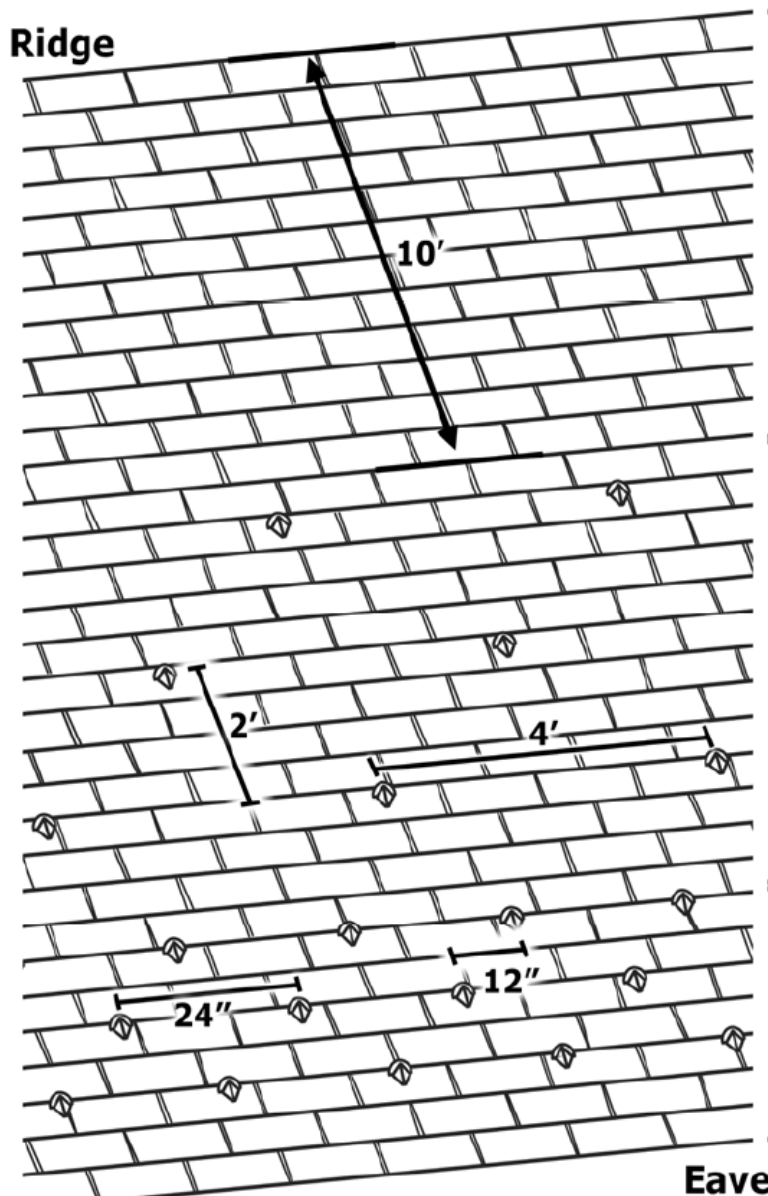

2 X 4 Layout – less than 75 psf Ground Snow Load and less than 16/12 roof pitch using 12 snow guards per square.

Top ten feet of rafter does not generally require snow guards except in extreme snow load areas.

2 X 4 Supplemental Pattern
(Alpine's standard layout)

This pattern is for installations using 12 snow guards per square including the standard three-row pattern. Space rows 2' vertically and 4' horizontally to within 10' of the ridge.

Standard Three-Row Pattern- For All Roofs

Three rows 24" on center horizontally with the middle row staggered 12".



Layout for Extreme Snow Areas Greater Than 75 psf Ground Snow Load

Most snow guard installations will use 12 snow guards per square with our standard 2 X 4 layout. If your project is in an extreme snow area, greater than 75 psf you will need to use a different layout. If your Ground Snow Load is between 75 psf and 110 psf use the 2 X 3 layout. If your Ground Snow Load is from 111 psf to 150 psf use the 2 X 2 layout.

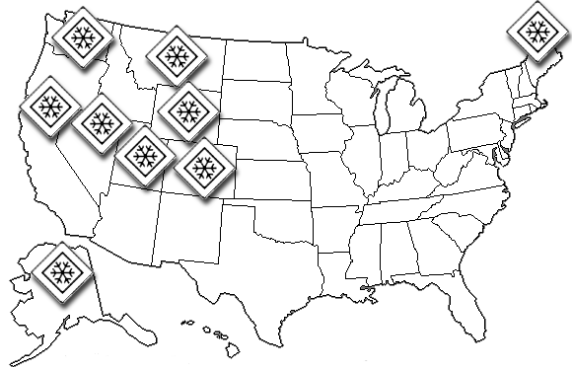

2 X 3 Pattern - for roofs 75 psf to 110 psf, 18 snow guards per square

2 X 2 Pattern - for roofs 111 psf to 150 psf, 24 snow guards per square

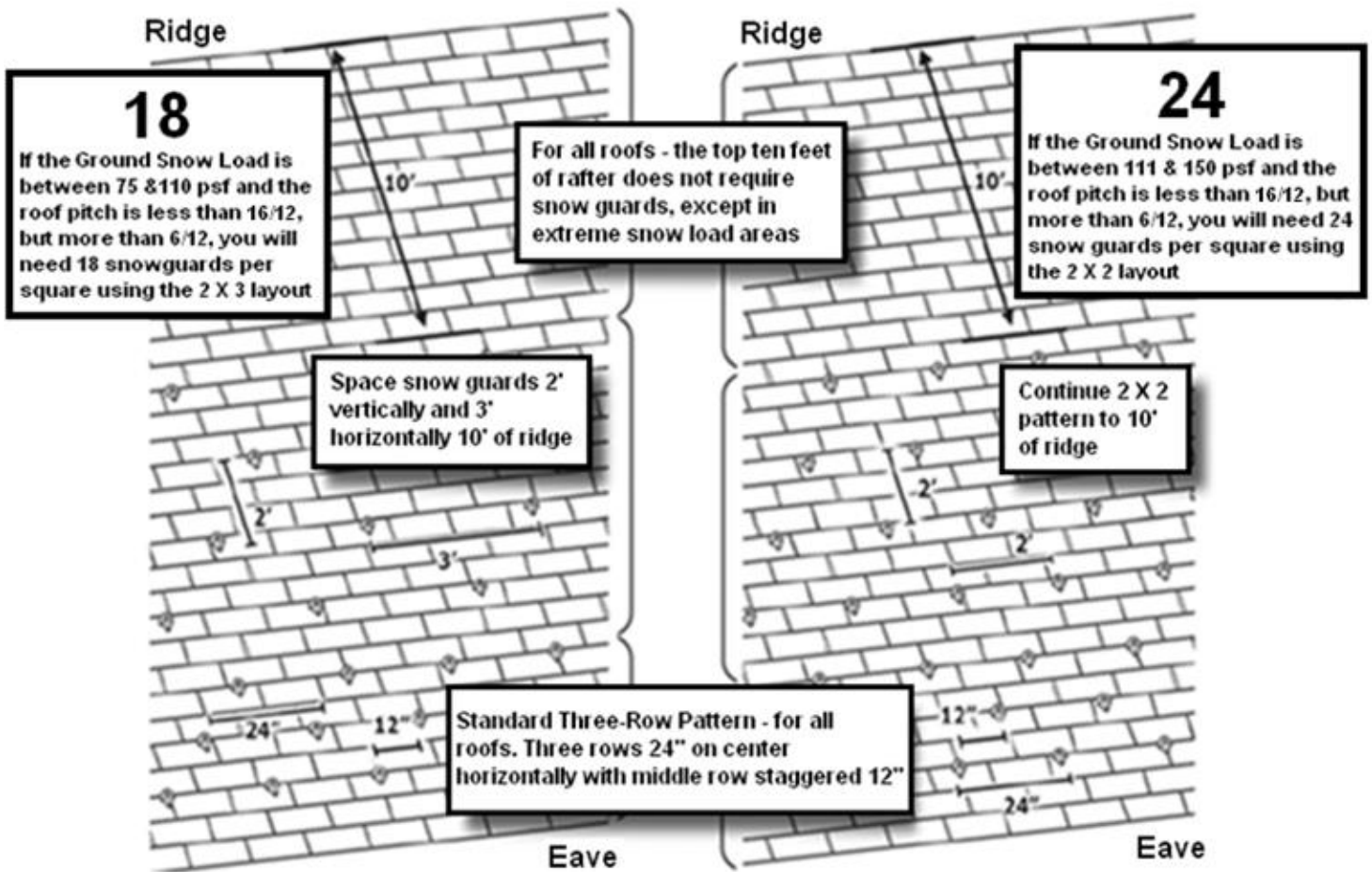

Document version 04.24.2015

